

KANZA FIRE COMMERCE PARK

A new 1,018 acre business park which is ready-to-build with flexible acreage for mixed-use land parcels ideal for industrial development, as well as science and research facilities. Served by 6,000 feet of BNSF Railway exposure and an on-site interchange for US Highway 75 plus quick interstate highway access to I-335 and I-70. The park is adjacent to a 2,000 acre foreign trade zone at Topeka Regional Airport which also has a 12,500 foot runway offering heavy air freight access.

- Mars is the First Occupant of Kanza Fire
- Total of 1,018 Acres- 868 Available Acres
- Flat Topography
- Zoning: Industrial- Heavy
- BNSF Rail Served
- Situated on Highway 75
- Adjacent to Topeka Regional Airport
- Utilities in Place
 - Electric: 3 Phase Power
 - Water: 12 Inch Water-line
 - Gas: 6 Inch Gas-line

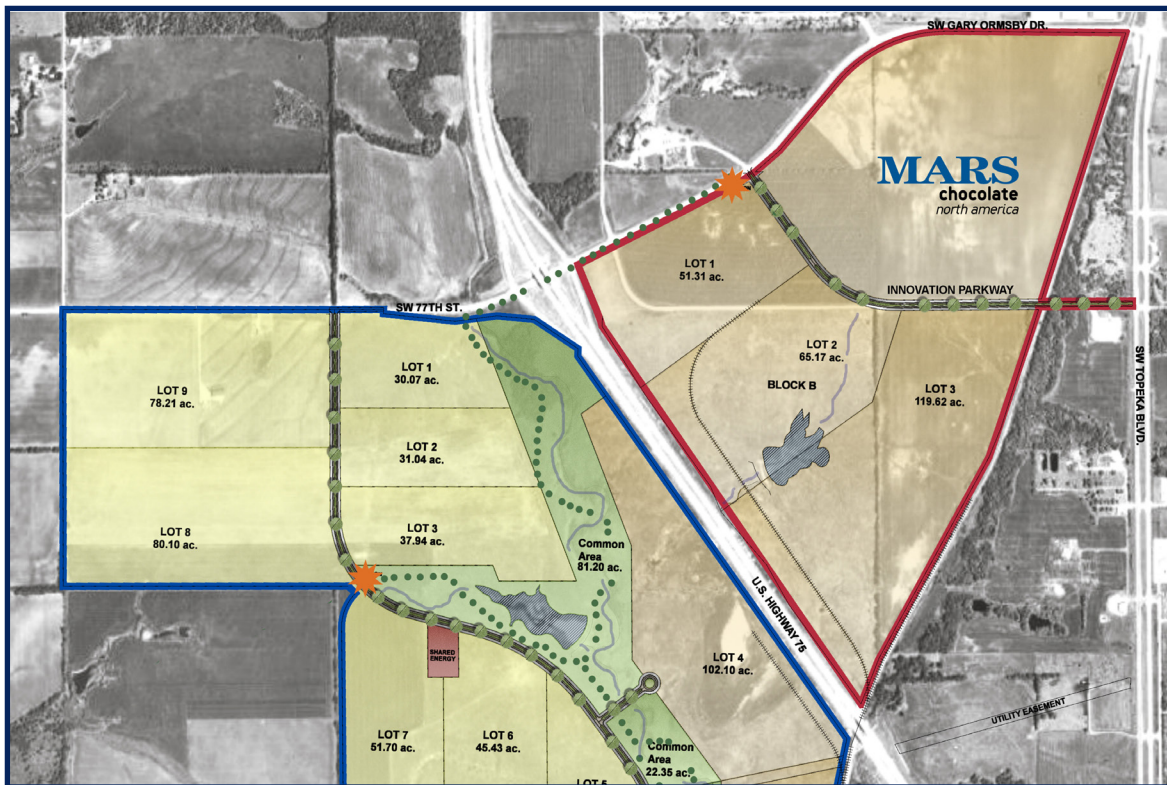

SW 77th Street and SW Topeka Boulevard, Topeka, Kansas 66619

Contact:

Scott Smathers
ssmathers@gotopeka.com
120 SE Sixth Avenue, Suite 110
Topeka, Kansas 66603
P: 785.234.2644
F: 785.234.8656

